

NILFISK®

EBK 340/KNFCH13830

Made in Germany

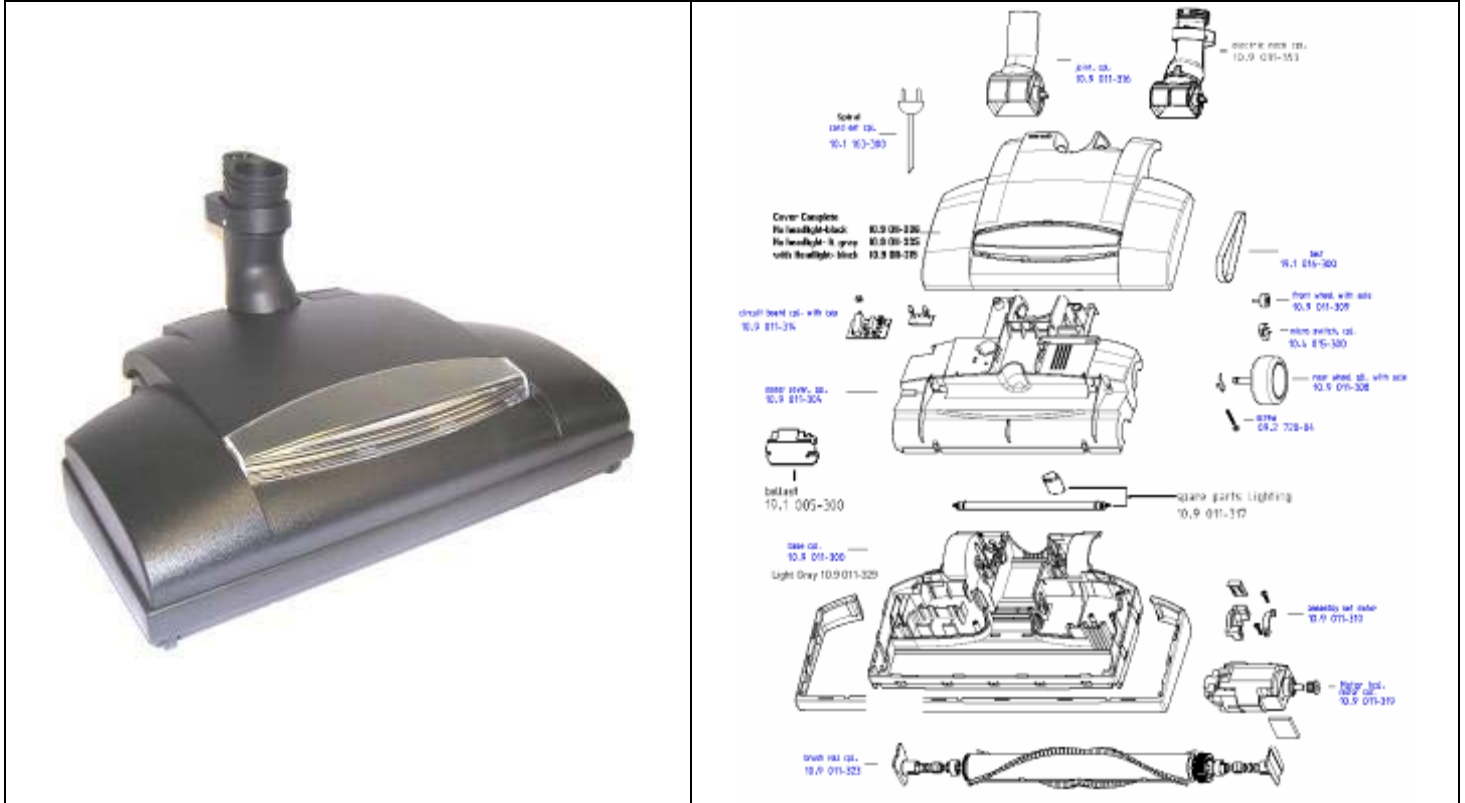

Description	Part Number	List
Cord- Coiled	10.1 163-300	\$ 6.50
Cover Complete-No Light-Black	10.9 011-336	\$ 60.00
Cover Complete-No Light-Light Gray	10.9 011-335	\$ 60.00
Cover Complete-w/Light-Black	10.9 011-315	\$ 60.00
Circuit Board/ red cap 120V 250W	10.9 011-314	\$ 55.00
Brush Roll complete	10.9 011-323	\$ 55.00
Ballast 120V	19.1 005-300	\$ 25.00
Base Complete - Black	10.9 011-300	\$ 75.00
Neck Complete w/button hole	10.9 011-316	\$ 20.00
QDC Neck Complete	10.7 028-300	\$ 60.00
Belt - Cogged	19.1 016-300	\$ 12.00
Light Kit-Starter and Tube	10.9 011-317	\$ 18.00
Motor Cover Complete (with light)	10.9 011-318	\$ 60.00
Motor Cover Complete (no light)	10.9 011-304	\$ 60.00
Micro Switch	10.4 015-300	\$ 31.50
Wheel - Rear w/Axle	10.9 011-308	\$ 20.00
Wheel - Front w/Axle	10.9 011-309	\$ 9.00
Motor Hardware (clamp/screw/wedge)	10.9 011-310	\$ 17.50
Motor Complete 120V 250W	10.9 011-319	\$ 80.00
Chrome telescoping wand	CH-PL4766-305	\$ 30.00